

Mastercam®

PRODUCTIVITY+™

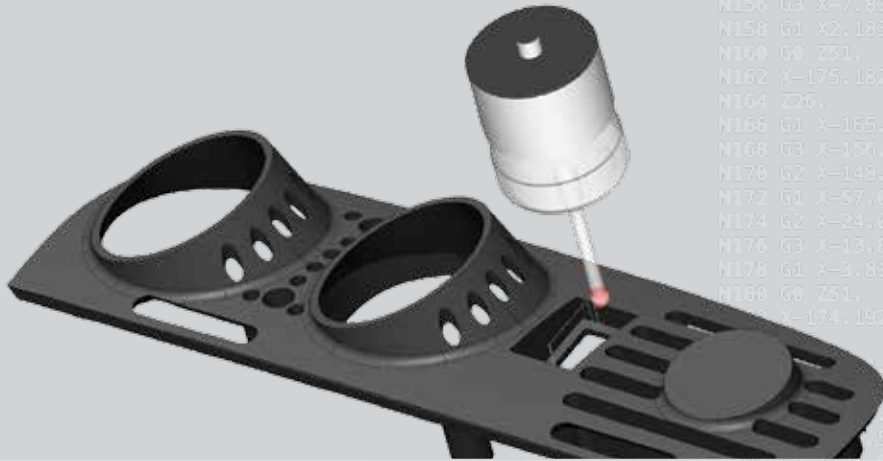

```
M138 G1 X8.182 Y148.523  
M140 G0 Z51.  
M142 X=161.122 Y69.186  
M144 Z26.  
M146 G1 X=171.222 Y78.514  
M148 G3 X=181.222 Y88.514 R10.  
M150 G2 X=191.222 Y98.514 R27.  
M152 G1 X=201.222 Y108.514  
M154 G2 X=18.938 Y149.932 R27.  
M156 G3 X=7.814 Y148.161 R10.001  
M158 G1 X2.183 Y148.387  
M160 G0 Z51.  
M162 X=175.182 Y69.951  
M164 Z26.  
M166 G1 X=165.282 Y71.359  
M168 G3 X=156.789 Y82.667 R10.  
M170 G2 X=148.044 Y102.826 R21.  
M172 G1 X=57.875 Y165.522  
M174 G2 X=24.936 Y149.796 R21.  
M176 G3 X=13.812 Y148.025 R10.  
M178 G1 X=3.815 Y148.252  
M180 G0 Z51.  
M182 X=174.192 Y78.892  
M184 G3 X=165.192 Y89.192 R10.  
M186 G2 X=156.447 Y102.007 R20.  
M188 G1 X=57.503 Y165.783  
M190 G0 Z51.  
M192 G1 X=174.192 Y78.892  
M194 G3 X=165.192 Y89.192 R10.  
M196 G2 X=156.447 Y102.007 R20.  
M198 G1 X=57.503 Y165.783  
M200 G0 Z51.
```

RENISHAW® PRODUCTIVITY+™ SOFTWARE SOLUTION WITHIN MASTERCAM

Productivity+ is an Add-On to Mastercam that allows you to program and simulate a Renishaw probe for your machine tool. This is a new solution for integrating process control into your CNC programs. Productivity+ will perform measurements and alignments, allowing you to set up and validate your parts at the machine tool. This leads to better process control and reporting of the performance of your machine tool.

Process Control

Close the loop by bringing setup and inspection onto the machine tool in process. Productivity+ handles part setup and alignment, tool setup and breakage detection, part inspection, and tool/position adjustment on the fly, right within the program.

Controller Support

Machine tools including 3-, 4-, and 5-axis configurations are supported via a wide range of post processors, providing a consistent level of functionality between machine types. This makes it possible to transfer one probing program between machine tools by simply reposting the program.

Self-Contained Processing

Since Productivity+ runs entirely on the machine tool, the program forms a self-contained package which operates in exactly the same way, every time a part is run. Once it's programmed, there is no need for an external PC, eliminating potential communications set-up issues.

Mastercam Add-On

Mastercam Productivity+ comes with unparalleled support from the World's #1 CAD/CAM software.
www.MastercamMill.com/ProductivityPlus

BE MORE PRODUCTIVE

Productivity+ provides an easy-to-use platform for incorporating simple measurement functionality and more advanced in-process intelligence into machining programs. It can simplify a wide range of measurement and process control tasks, such as component set-up and part verification, and aids process development in the following key areas:

- Stock and tool setup.
- Predictive process setting—performing simple tests to ensure that a machine process will be successful.
- Active in-process control—using the probe to measure features and update machining process based on the results obtained.
- Informative reporting—providing information about the in-process state of a component, and about the decisions that were made when producing it.
- Productivity+ creates programs which run entirely on the machine tool, including all the calculations, updates, and logic which are needed—so no external PC is required to process measurement data.

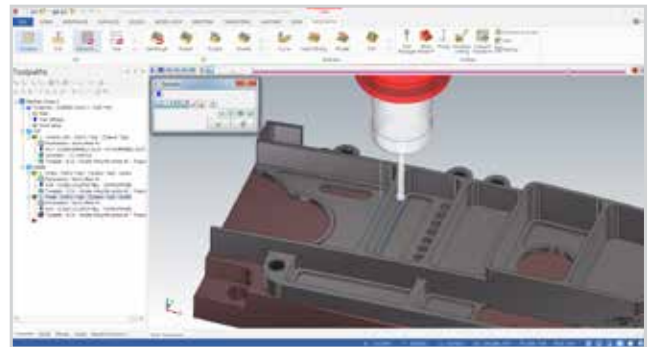
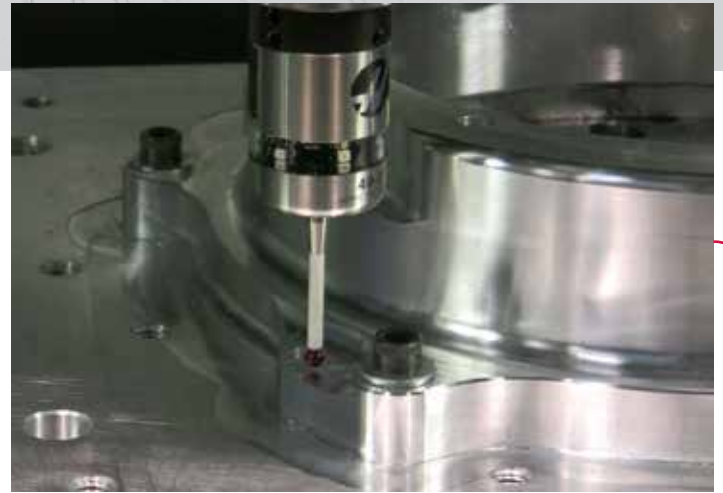

For more information, visit
MastercamMill.com/ProductivityPlus

CNC Software, Inc.
671 Old Post Road
Tolland, CT 06084



www.mastercam.com

Mastercam[®]
Be Dynamic.

Mastercam[®] is a registered trademark of CNC Software, Inc. ©1983-2016. All rights reserved.
All other trademarks are property of their respective owners.